

Wing A - Refuge Floor Plan



Area Statement : Wing - A (all areas in sq.m)

Flat Nos	Type	Carpet Area	Balcony Area	Total Area
G06, G07	Type 1	59.50	3.10	62.60
G08, G09	Type 2	59.00	3.10	62.10
101, 102, 104, 105, 108, 109, 1801, 1802, 1804, 1805, 1808, 1809	Type 2	59.00	3.10	62.10
103, 1803	Type 3	58.00	3.10	61.10
106, 107, 1806, 1807	Type 1	59.50	3.10	62.60
1903, 2003	Type 3	58.00	3.10	61.10
1904, 1905, 1908, 1909, 2004, 2005, 2008, 2009	Type 2	59.00	3.10	62.10
1906, 1907, 2006, 2007	Type 1	59.50	3.10	62.60

Wing A - Typical Floor Plan



Area Statement : Wing - A (all areas in sq.m)

Flat Nos	Type	Carpet Area	Balcony Area	Total Area
G06, G07	Type 1	59.50	3.10	62.60
G08, G09	Type 2	59.00	3.10	62.10
101, 102, 104, 105, 108, 109, 1801, 1802, 1804, 1805, 1808, 1809	Type 2	59.00	3.10	62.10
103, 1803	Type 3	58.00	3.10	61.10
106, 107, 1806, 1807	Type 1	59.50	3.10	62.60
1903, 2003	Type 3	58.00	3.10	61.10
1904, 1905, 1908, 1909, 2004, 2005, 2008, 2009	Type 2	59.00	3.10	62.10
1906, 1907, 2006, 2007	Type 1	59.50	3.10	62.60

Wing B - Refuge Floor Plan



Area Statement : Wing - B (all areas in sq.m)

Flat Nos	Type	Carpet Area	Balcony Area	Total Area
G05 , G06, G07, G08	Type 2	59.00	3.10	62.10
101, 102,103, 104, 105, 106, 107, 108 . . . 1801, 1802, 1803, 1804, 1805, 1806, 1807, 1808	Type 2	59.00	3.10	62.10

Wing B - Typical Floor Plan



Area Statement : Wing - B (all areas in sq.m)

Flat Nos	Type	Carpet Area	Balcony Area	Total Area
G05 , G06, G07, G08	Type 2	59.00	3.10	62.10
101, 102,103, 104, 105, 106, 107, 108 . . . 1801, 1802, 1803, 1804, 1805, 1806, 1807, 1808	Type 2	59.00	3.10	62.10

Wing C - Refuge Floor Plan



Area Statement : Wing - C (all areas in sq.m)

Flat Nos	Type	Carpet Area	Balcony Area	Total Area
G03, G04, G07, G08	Type 2	59.00	3.10	62.10
G09	Type 3	58.00	3.10	61.10
G05, G06	Type 1	59.50	3.10	62.60
101, 102, 103, 104, 107, 108, 1801, 1802, 1803, 1804, 1807, 1808	Type 2	59.00	3.10	62.10
105, 106, 1805, 1806	Type 1	59.50	3.10	62.60
109, 1809	Type 3	58.00	3.10	61.10
1903, 1904, 1907, 1908, 2003, 2004, 2007, 2008	Type 2	59.00	3.10	62.10
1905, 1906, 2005, 2006	Type 1	59.50	3.10	62.60
1909, 2009	Type 3	58.00	3.10	61.10

Wing C - Typical Floor Plan



Area Statement : Wing - C (all areas in sq.m)

Flat Nos	Type	Carpet Area	Balcony Area	Total Area
G03, G04, G07, G08	Type 2	59.00	3.10	62.10
G09	Type 3	58.00	3.10	61.10
G05, G06	Type 1	59.50	3.10	62.60
101, 102, 103, 104, 107, 108, 1801, 1802, 1803, 1804, 1807, 1808	Type 2	59.00	3.10	62.10
105, 106, 1805, 1806	Type 1	59.50	3.10	62.60
109, 1809	Type 3	58.00	3.10	61.10
1903, 1904, 1907, 1908, 2003, 2004, 2007, 2008	Type 2	59.00	3.10	62.10
1905, 1906, 2005, 2006	Type 1	59.50	3.10	62.60
1909, 2009	Type 3	58.00	3.10	61.10

2 BHK Unit Plan (Type-1)

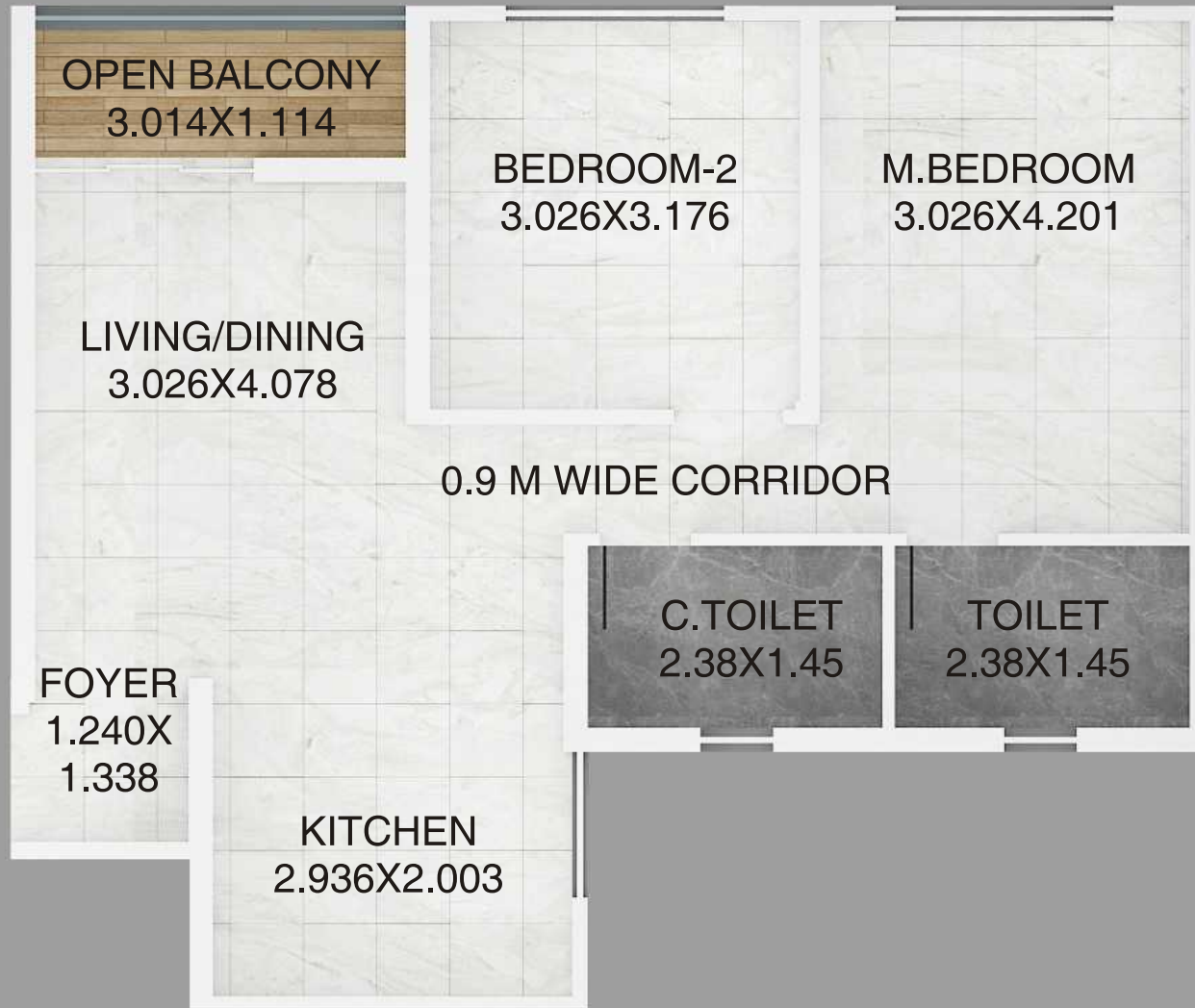

2 BHK Unit Plan (Type-2)



2 BHK Unit Plan (Type-3)

